

21

T45N R5W - M.D.M.

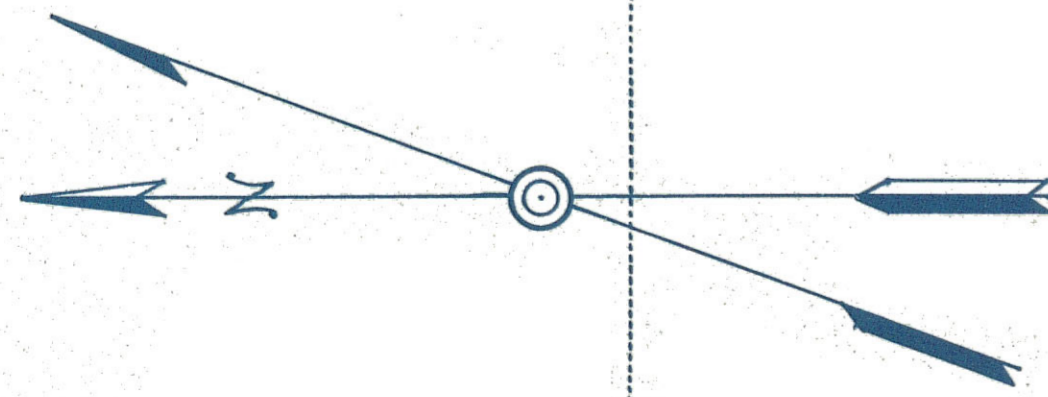

O. CONNER

DREYER

O. CONNER

LONG

Company Ditch

No Crop

Sec. 21

Sec. 27

Sec. 21

Sec. 28

Sec. 27

Sec. 28

Wheat (1921) 17<sup>2</sup>Ac.

Wheat (1921) 4<sup>2</sup>Ac.

Alfalfa 30<sup>3</sup>Ac.

Alfalfa 10<sup>2</sup>Ac.

Alfalfa 42<sup>4</sup>Ac.

Grain 6<sup>9</sup>Ac.

Alfalfa 30<sup>5</sup>Ac.

Alfalfa 13<sup>4</sup>Ac.

Alfalfa 2<sup>3</sup>Ac.

Alfalfa (1921) 10<sup>2</sup>Ac.

Pasture 3<sup>3</sup>Ac.

Pasture 30<sup>8</sup>Ac.

Hay 87<sup>4</sup>Ac.

Hay 14<sup>2</sup>Ac.

Pasture 16<sup>5</sup>Ac.

Pasture 10<sup>6</sup>Ac.

Hay 3<sup>5</sup>Ac.

Hay 6<sup>2</sup>Ac.

Alfalfa 27<sup>2</sup>Ac.

Alfalfa 43<sup>4</sup>Ac.

Alfalfa 22<sup>5</sup>Ac.

Pasture 18<sup>8</sup>Ac.

Alfalfa 38<sup>2</sup>Ac.

Alfalfa 26<sup>4</sup>Ac.

Alfalfa 8<sup>2</sup>Ac.

Alfalfa 7<sup>1</sup>Ac.

Alfalfa 12<sup>8</sup>Ac.

Hay 28<sup>2</sup>Ac.

Hay 20<sup>3</sup>Ac.

Hay 20<sup>7</sup>Ac.

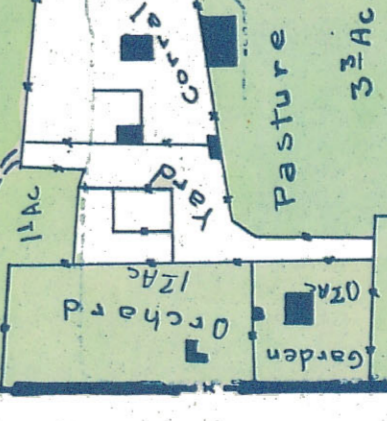

STATE OF CALIFORNIA DEPARTMENT OF PUBLIC WORKS DIVISION OF WATER RIGHTS LANDS IRRIGATED FROM SHASTA RIVER AND TRIBUTARIES SISKIYOU COUNTY CALIFORNIA

M.D. 5327