

(Sheet 78)

T. 42 N., R. 5 W. M.D.M

(Sheet 77)

(Sheet 31)

Sec. 8
Sec. 17
Sec. 9
Sec. 16

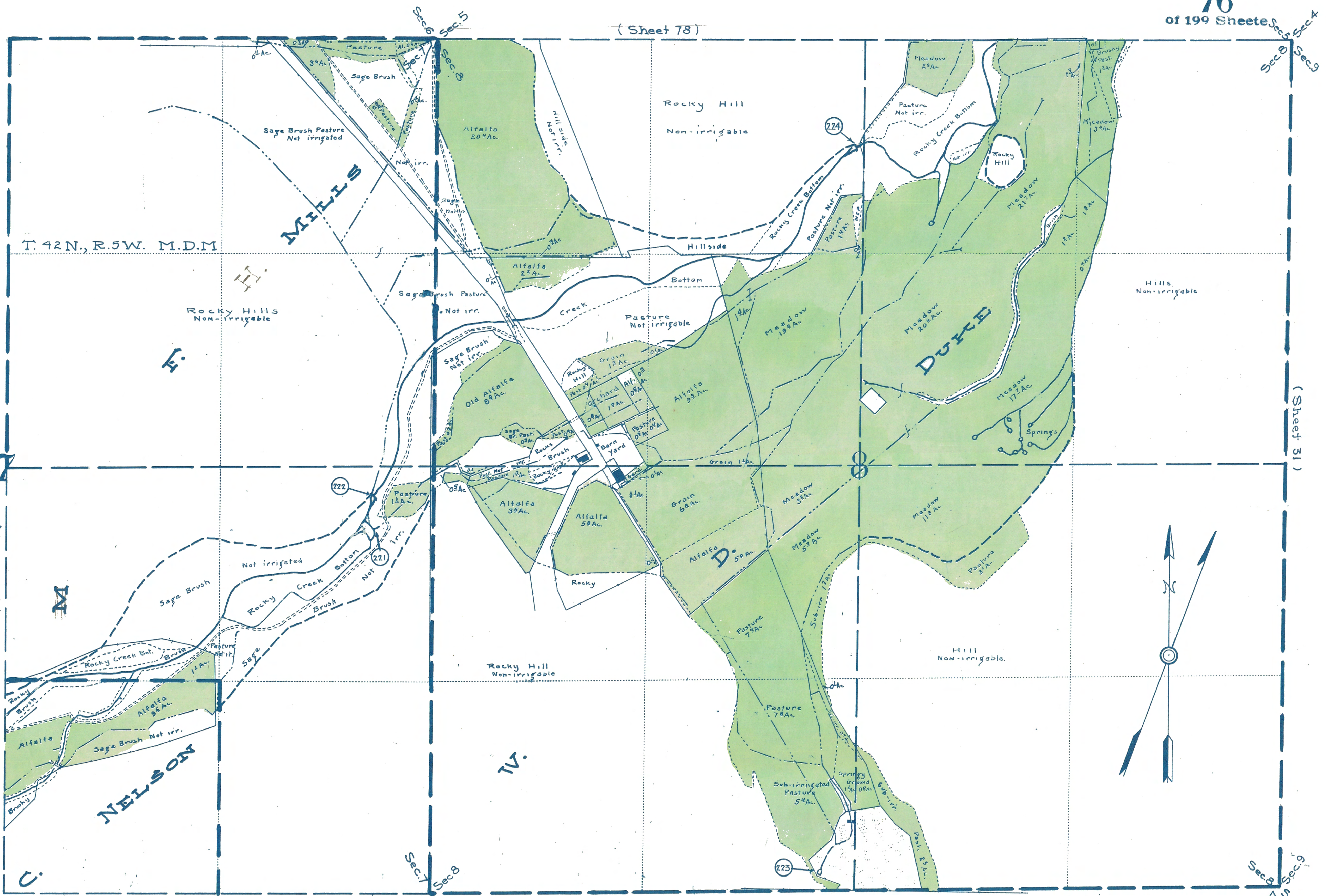

(Sheet 74)

STATE OF CALIFORNIA
DEPARTMENT OF PUBLIC WORKS
DIVISION OF WATER RIGHTS
**LANDS IRRIGATED FROM SHASTA RIVER
AND TRIBUTARIES
SISKIYOU COUNTY CALIFORNIA** M.D. 5327
SHOWN BY A.

SCALE 1" = 300 FT. TRANSIT AND STADIA SURVEY

1923

76