

Sec. 35 Sec. 36  
T. 44N. M.D.M.  
T. 43N. M.D.M.  
Sec. 2 Sec. 1

Sec. 36 Sec. 31  
Sec. 1  
R. 6W. M.D.M.  
R. 5W. M.D.M.

**ORR**

**Bros.**

(Sheet 110)

(Sheet 111)

(Sheet 107)

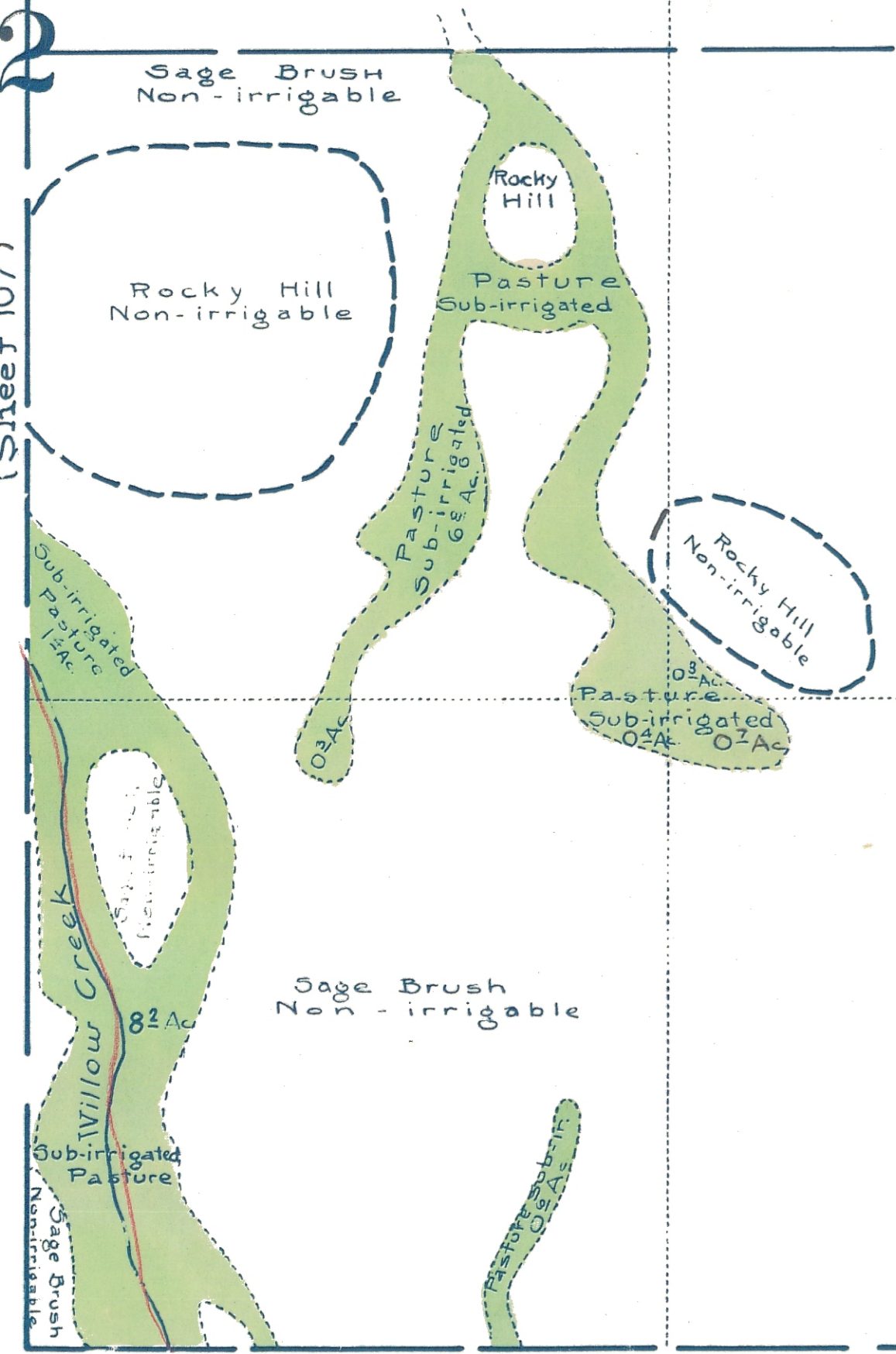

Sage Brush Non-irrigable

Rocky Hill Non-irrigable

Sage Brush Non-irrigable

Pasture Sub-irrigated 31<sup>2</sup>Ac

Pasture 4<sup>2</sup>Ac

Pasture Sub-irrigated 21<sup>2</sup>Ac

Hillside Not irrigated

Hillside Not irrigated

Sec. 2  
Sec. 11 Sec. 12  
Sec. 1

(Sheet 69)

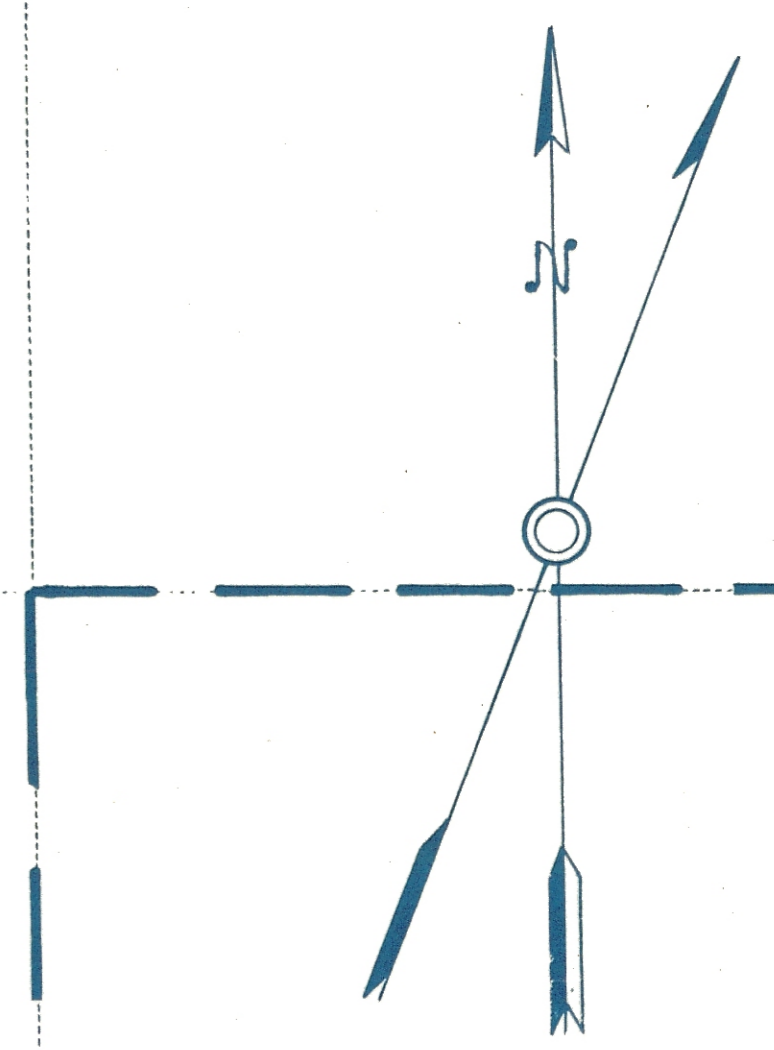

MT. SHASTA LAND  
&  
IRRIGATION COMPANY

Sec. 1  
Sec. 6  
Sec. 12 Sec. 7

STATE OF CALIFORNIA  
DEPARTMENT OF PUBLIC WORKS  
DIVISION OF WATER RIGHTS  
**LANDS IRRIGATED FROM SHASTA RIVER  
AND TRIBUTARIES**  
**SISKIYOU COUNTY CALIFORNIA**  
SHOWN BY A  
**PLANE TABLE SURVEY**

M.D. 5327

SCALE 1" = 300 FT

1925

70