

STATE OF CALIFORNIA  
DEPARTMENT OF PUBLIC WORKS  
DIVISION OF WATER RIGHTS  
LANDS IRRIGATED FROM SHASTA RIVER  
AND TRIBUTARIES  
SISKIYOU COUNTY CALIFORNIA

Sheet  
**125**  
of 199 Sheets

SHOWN BY A  
PLANE TABLE SURVEY

1922

SCALE 1" = 300 FT.

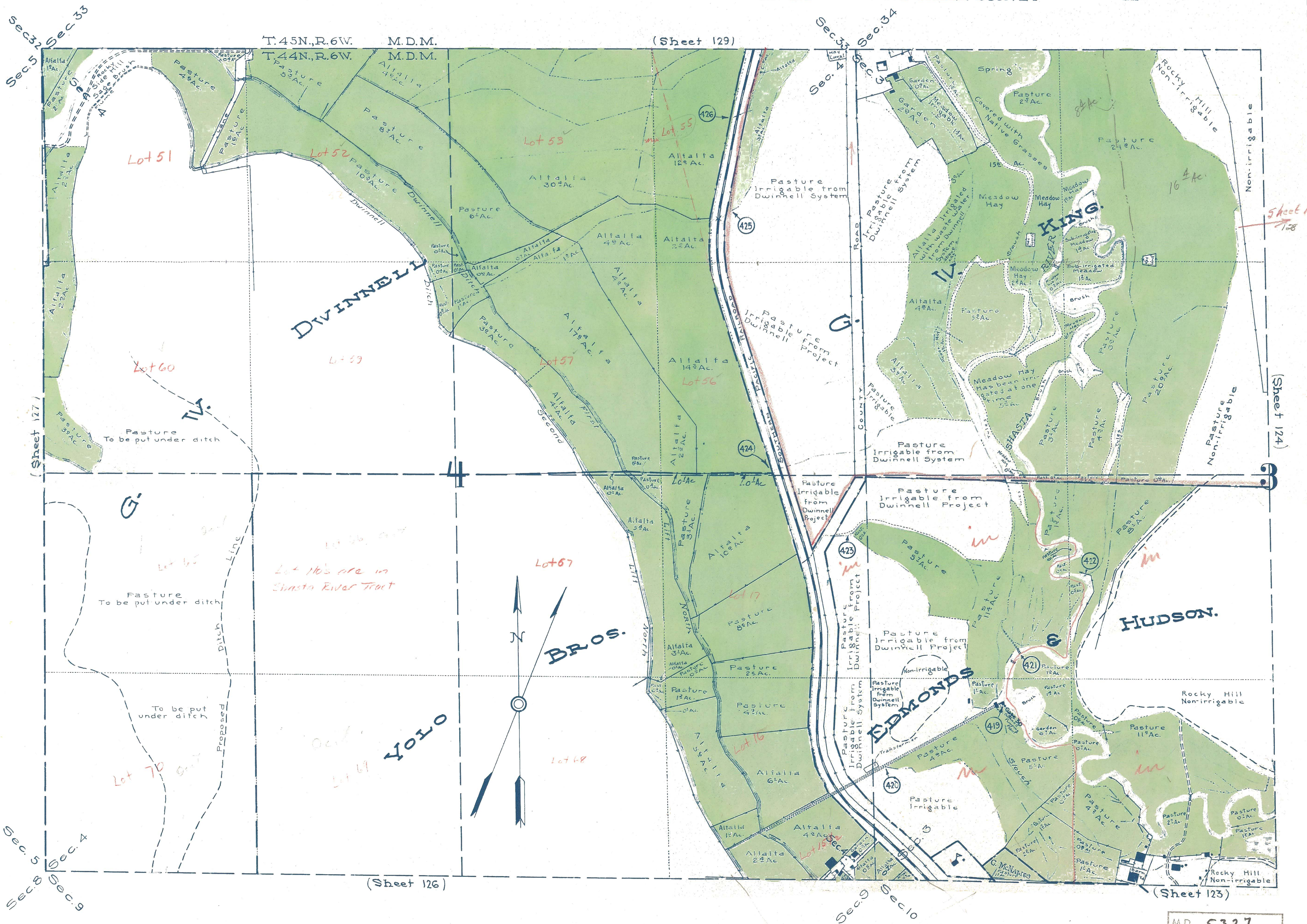

T.45N., R.6W. M.D.M.  
T.44N., R.6W. M.D.M.

(Sheet 129)

(Sheet 126)

(Sheet 124)

(Sheet 123)

M.D. 5327